

WILTSHIRE ROUTE 12 - CORSHAM > EASTON

- ✓ From Wp **START**. With your back towards Corsham Court go through the kissing gate in front & turn half L & cross stile. Follow wall on L to its corner @ **Wp1**.
- ① Swing L & follow wall, then follow HAHA ditch on L through 2 kissing gates to footpath signpost @ **Wp2**.
- ② Swing half R between 2 trees. Aim for stile on edge of copse where there appears to be a small clearing. **Wp3**.
- ③ Go into copse & over bridge to enter large field. Swing R & Walk down centre of field to kissing gate in fence. Through gate & aim for small gate @ far L corner of field @ **Wp4**.
- ④ Turn R along Rd. Pass Rd on R then look for stile in hedge just before the Rd swings L. **Wp5**.
- ⑤ Cross stile & walk down centre of field to stile in wall just R of the cottage. Cross stile & aim for gap in wall just R of next cottage. Meet Rd @ **Wp6**.
- ⑥ Cross Rd & over stile. Aim for RHS of cottage. On far side of cottage turn L between 2 walls @ **Wp7** to meet Rd @ **Wp8**.
- ⑧ Turn R down Rd to path on R just after small lake. **Wp9**.
- ⑨ Cross stile & aim diagonally L across field to far corner @ **Wp10**.
- ⑩ Swing R & follow hedge on R to meet Rd @ **Wp11**.
- ⑪ Cross rd & stile opposite. Cross field to kissing gate to L of Barn. Go straight on, cross track to enter Corsham Park with lake on R. Aim for church spire to bring you back to **Wp START** again.

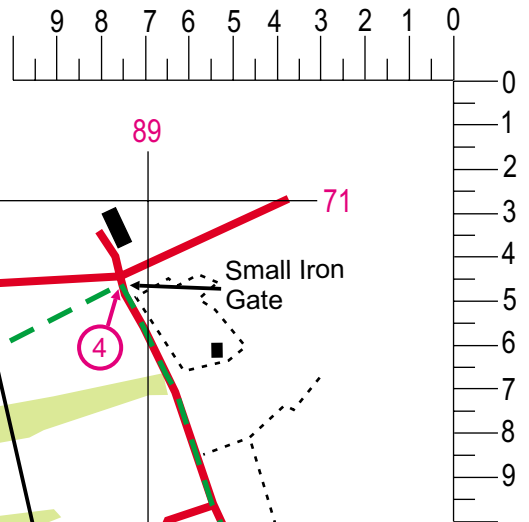
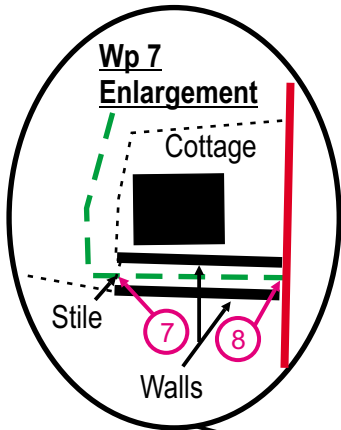

- Road —
- Route - - -
- Other Path - · - · -
- Field Boundary - · - · -
- Track —
- Plot Line - · - · -

0 Miles — 0.5  
 © T T Walker 28/12/01 All rights reserved

